

HUNTERS®

HERE TO GET *you* THERE

203 Dover Road, Northfleet, Gravesend, Kent, DA11 9QN

Guide Price £290,000

Property Images



HUNTERS®

HERE TO GET *you* THERE

Property Images



HUNTERS®

HERE TO GET *you* THERE

GROUND FLOOR
410 sq.ft. (38.1 sq.m.) approx.

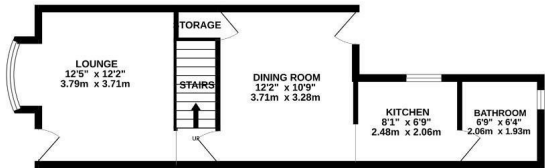

1ST FLOOR
400 sq.ft. (37.1 sq.m.) approx.

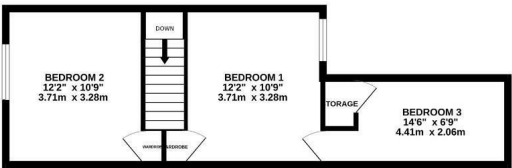

DOVER ROAD, NORTHFLEET, GRAVESEND, DA11

TOTAL FLOOR AREA : 810 sq.ft. (75.3 sq.m.) approx.

Whilst every attempt has been made to ensure the accuracy of the floorplan contained here, measurements of doors, windows, rooms and any other items are approximate and no responsibility is taken for any error, omission or mis-statement. This plan is for illustrative purposes only and should be used as such by any prospective purchaser. The services, systems and appliances shown have not been tested and no guarantee as to their operability or efficiency can be given.

Made with Metropix C2025

EPC

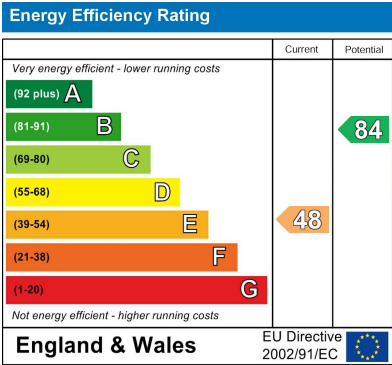

Map



Details

Type: House - Terraced Beds: 3 Bathrooms: 1 Reception: 1 Tenure: Freehold

Summary

GUIDE PRICE £290,000-£300,000.

We are proud to offer for sale this three bedroom terraced home offering an excellent opportunity for both first time buyers and those looking to invest, with its convenient location being close to three mainline railway stations, Gravesend Town Centre and local shops nearby.

The property boasts lounge, dining room, modern kitchen and bathroom on the ground floor.

Whilst the first floor has three good sized bedrooms, with two being equipped with built in wardrobe space.

Additional benefits include a low maintenance front garden and a spacious rear garden with a decked area, ideal for those looking for outdoor space.

Features

Furthermore this property comes with NO FORWARD CHAIN so call now to arrange a viewing!

• THREE BEDROOMS • LOUNGE • DINING
ROOM • KITCHEN • BATHROOM • GARDEN • CHAIN FREE • EPC RATING E